

the floorplan...

FIRST FLOOR
441 sq.ft. (40.9 sq.m.) approx.

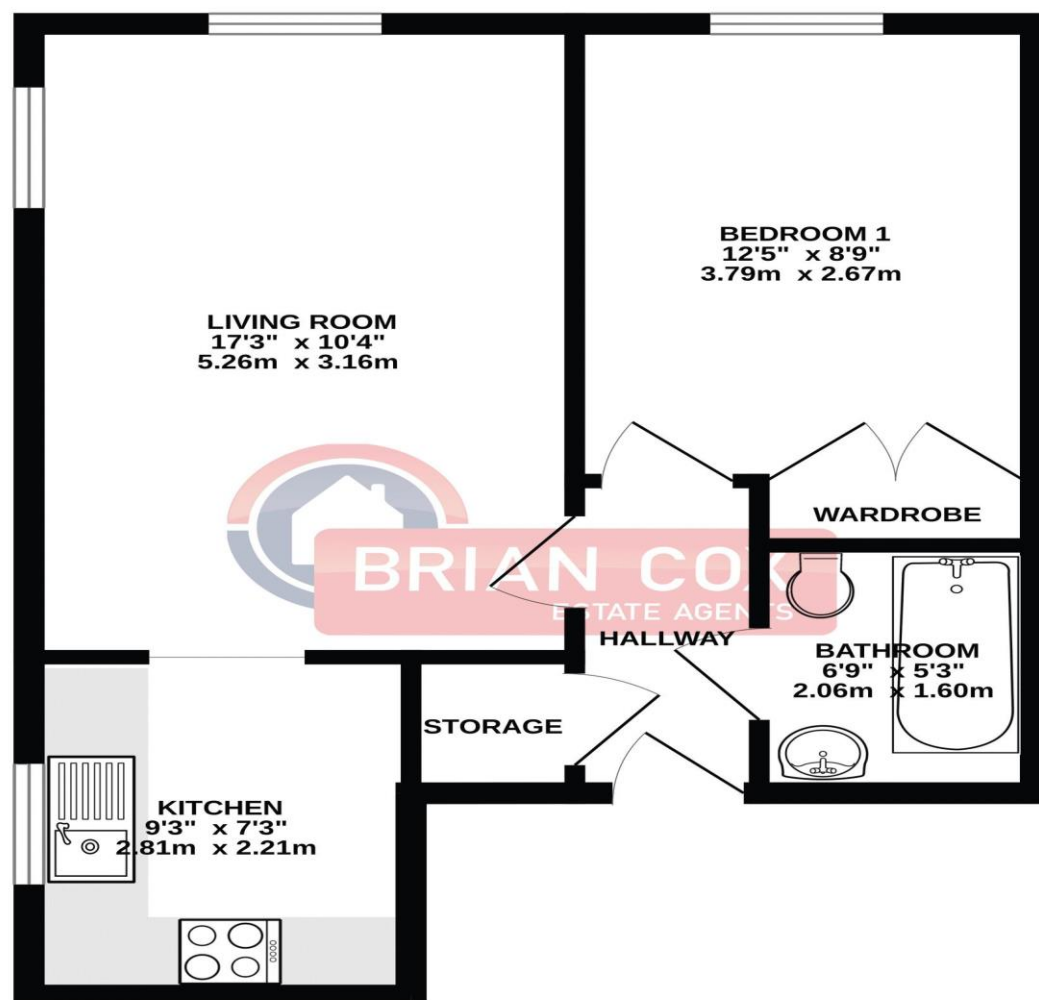

TOTAL FLOOR AREA : 441 sq.ft. (40.9 sq.m.) approx.
Whilst every attempt has been made to ensure the accuracy of the floorplan contained here, measurements of doors, windows, rooms and any other items are approximate and no responsibility is taken for any error, omission or mis-statement. This plan is for illustrative purposes only and should be used as such by any prospective purchaser. The services, systems and appliances shown have not been tested and no guarantee as to their operability or efficiency can be given.
Made with Metropix ©2023

more details from...

call: **Brian Cox Harrow: 0208 912 0006**
email: info@brian-cox.co.uk
web: www.brian-cox.co.uk



Consumer Protection from Unfair Trading Regulations 2008 We have not tested any apparatus, equipment, fixtures, fittings or services and so cannot verify that they are in working order or fit for purpose. You are advised to obtain verification from your solicitor or surveyor. References to the tenure of a property are based on information supplied by the seller. We have not had sight of the title documents and a buyer is advised to obtain verification from their solicitor. Items shown in photographs are not included unless specifically mentioned within the sales particulars, but may be available by separate negotiation. We advise you to book an appointment to view before embarking on any journey to see a property, and check its availability.



0208 912 0006
brian-cox.co.uk



RETIREMENT APARTMENT - OVER 60'S - ONE
BEDROOM - RESIDENTS PARKING -
COMMUNAL GROUNDS

Brian Cox is pleased to present to the market this popular retirement development for the over 60's. This property provides easy access to Harrow Town Centre and its multitude of shops and transport links. This apartment is situated on the first floor and comprises of a lounge, kitchen, bedroom, and bathroom. The property benefits from double glazing, electric heating, resident's lounges, laundry room, communal grounds, and residents parking.



£160,000
Leasehold

Sheepcote Road, Harrow HA1 2JU



in brief...

- Retirement Apartment
- Over 60's
- First Floor
- One Bedroom
- Residents Parking
- Communal Grounds



the location...

nearest stations ...

Harrow-on-the-Hill (0.4 miles)
Northwick Park (0.4 miles)
Kenton (0.5 miles)

Harrow-on-the-Hill Station, although named after the settlement, is located some distance to the North of the hill. The London Underground service at Harrow-on-the-Hill is provided by the Metropolitan Line, and the station is also served by the Chiltern Railways London to Aylesbury Line. These services run in to central London, and out West/North West to the outer reaches of London and beyond.

Harrow on the Hill is an affluent area of North West London, England, and part of the London Borough of Harrow. The name refers to Harrow Hill.

Harrow has two large shopping centres which are St Anns and St Georges with its many large department stores, restaurants, cafes and cinema. You have a large Tesco's & Morrison's which are both within a short drive to the property.